

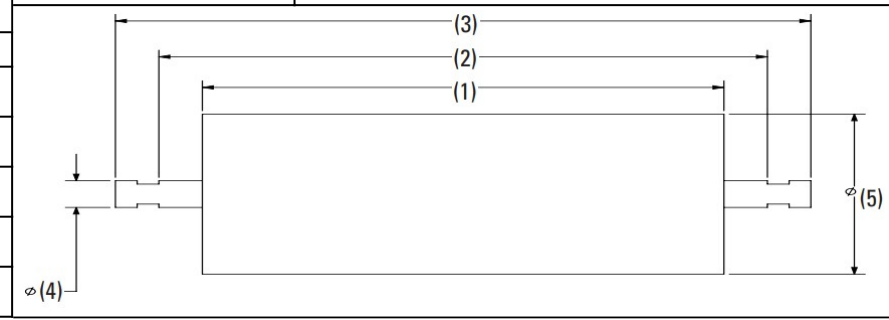

REQUEST ORDER:	2529	SITE CONTACT NAME:	NSM - Silver Bay	Are you sending in a roll for measurement?	<input type="radio"/> Yes <input checked="" type="radio"/> No																		
DISTRIBUTOR:	QCS - VaMN	SITE NUMBER:	N/A	Do you need rolls back?	<input type="radio"/> Yes <input checked="" type="radio"/> No																		
SITE:	North Shore Mine - Silver Bay	ROLL PERFORMANCE INTEREST:	If yes, where?																				
CONVEYOR NUMBER:		<input checked="" type="checkbox"/> WEAR LIFE	<input type="checkbox"/> NOISE																				
ROLL MANUFACTURER:	Link Belt	<input checked="" type="checkbox"/> WEIGHT	<input type="checkbox"/> RECYCLABILITY																				
FRAME MANUFACTURER:	Link Belt	<input type="checkbox"/> POWER CONSUMPTION	<input type="checkbox"/> CORROSION																				
BELT WIDTH:	IN. <input type="text"/> MM <input type="text"/>	ROLL LOCATION: (Select one)																					
BELT SPEED:	N/A	<input type="radio"/> EQUAL TROUGH <input type="radio"/> CENTER TROUGH <input type="radio"/> WING TROUGH <input checked="" type="radio"/> FLAT RETURN <input type="radio"/> VEE RETURN																					
TONS PER HOUR:	N/A	ROLL CEMA RATING: (Select one)																					
ROLLER DIMENSIONS: <table border="1"> <thead> <tr> <th></th> <th>INCHES</th> <th>MILLIMETERS</th> </tr> </thead> <tbody> <tr><td>1</td><td>7.500</td><td>190.50</td></tr> <tr><td>2</td><td>8.000</td><td>203.2</td></tr> <tr><td>3</td><td>8.750</td><td>222.25</td></tr> <tr><td>4</td><td>.750</td><td>19.05</td></tr> <tr><td>5</td><td>6.00</td><td>152.4</td></tr> </tbody> </table>			INCHES	MILLIMETERS	1	7.500	190.50	2	8.000	203.2	3	8.750	222.25	4	.750	19.05	5	6.00	152.4	FRAME TROUGHING ANGLE: (Select one) <input type="radio"/> 20% <input type="radio"/> 35% <input type="radio"/> 45% <input type="radio"/> OTHER			
			INCHES	MILLIMETERS																			
1	7.500	190.50																					
2	8.000	203.2																					
3	8.750	222.25																					
4	.750	19.05																					
5	6.00	152.4																					
ROLLER OPERATING TEMPERATURE RANGE <input type="radio"/> Less than -22°F (-30°C) <input checked="" type="radio"/> Between -22°F (-30°C) and 140°F (60°C) <input type="radio"/> Above 140°F (60°C)																							
		SPACING BETWEEN FRAMES		N/A																			
		MATERIAL CONVEYED		N/A																			
		LENGTH OF TRIAL/TEST		ROLL QUANTITY																			



SHAFT END DETAILS—TYPE: (Select one)										
<input type="radio"/> A	<input type="radio"/> B	<input type="radio"/> C	<input checked="" type="radio"/> D	<input type="radio"/> F	<input type="radio"/> G	<input type="radio"/> H	<input type="radio"/> J	<input type="radio"/> K	<input type="radio"/> L	
DIMENSIONS	INCHES	MILLIMETERS								
F										
G										
H										
I										
J										