

<p>Quality Conveyor Solutions</p> <p>board not found as type unknown</p>	REQUEST ORDER:	2512	SITE CONTACT NAME:		Are you sending in a roll for measurement?	<input type="radio"/> Yes <input type="radio"/> No
	DISTRIBUTOR:	Test	SITE NUMBER:		Do you need rolls back?	<input type="radio"/> Yes <input type="radio"/> No
	SITE:		ROLL PERFORMANCE INTEREST:	If yes, where?		
	CONVEYOR NUMBER:		<input type="checkbox"/> WEAR LIFE	<input type="checkbox"/> NOISE		
	ROLL MANUFACTURER:		<input type="checkbox"/> WEIGHT	<input type="checkbox"/> RECYCLABILITY		
	FRAME MANUFACTURER:		<input type="checkbox"/> POWER CONSUMPTION	<input type="checkbox"/> CORROSION		
ROLLER DIMENSIONS:		BELT WIDTH:	IN.	MM		
	INCHES	MILLIMETERS				
1			ROLL LOCATION: (Select one) <input type="radio"/> EQUAL TROUGH <input type="radio"/> CENTER TROUGH <input type="radio"/> WING TROUGH <input type="radio"/> FLAT RETURN <input type="radio"/> VEE RETURN			
2			ROLL CEMA RATING: (Select one) <input type="radio"/> B <input type="radio"/> C <input type="radio"/> D <input type="radio"/> E <input type="radio"/> F			
3			FRAME TROUGHING ANGLE: (Select one) <input type="radio"/> 20% <input type="radio"/> 35% <input type="radio"/> 45% <input type="radio"/> OTHER			
4			ROLLER OPERATING TEMPERATURE RANGE <input type="radio"/> Less than -22°F (-30°C) <input type="radio"/> Between -22°F (-30°C) and 140°F (60°C) <input type="radio"/> Above 140°F (60°C)			
5			SPACING BETWEEN FRAMES			
			MATERIAL CONVEYED			
			LENGTH OF TRIAL/TEST		ROLL QUANTITY	

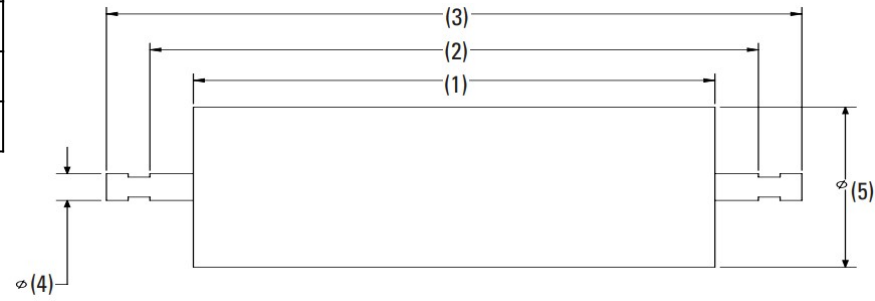

SHAFT END DETAILS—TYPE: (Select one)				
<input type="radio"/> A <input type="radio"/> B <input type="radio"/> C <input type="radio"/> D <input type="radio"/> F <input type="radio"/> G <input type="radio"/> H <input type="radio"/> J <input type="radio"/> K <input type="radio"/> L				
DIMENSIONS	INCHES	MILLIMETERS		
F				
G				
H				
I				
J				
TYPE—A			TYPE—D	
TYPE—F			TYPE—J	
TYPE—B			TYPE—K	
TYPE—G			TYPE—L	
TYPE—C			TYPE—H	
			NOTES	